



Model: LPS-950
Hand Push Sweeper Operation Manual



TABLE OF CONTENTS

PREREQUISITES	3
1. SAFETY INSTRUCTIONS	4
1.1 INTENDED USE	4
1.2 SAFETY INSTRUCTIONS FOR OPERATION/MAINTAINING OPERATING SAFETY	5
2. INSTRUCTIONS FOR USE	6
3. INSTALLATIONS INSTRUCTIONS	7
4. OPERATING THE SWEEPER	8
5. SWEEPER ADJUSTMENTS	8
5.1 ADJUSTING HEIGHT OF BRUSH	9
5.2 MAIN BRUSH ADJUSTING HANDLE	9
5.3 FRONT BRUSH ADJUSTING HANDLE	9
5.4 ADJUSTMENTS AND CAUTIONS	9
5.5 CLEANING	10
6. MAINTENANCE AND TROUBLESHOOTING	11
6.1 CLEANING THE MACHINE	11
7. MAINTENANCE AND TROUBLESHOOTING	11
APPENDIX 1 - ABOUT THESE INSTRUCTIONS.....	12
A1.1 TECHNICAL FURTHER DEVELOPMENT	12
A1.2 TARGET GROUP	12
PARTS AND AFTER SALES SERVICES.....	12

Prerequisites

- Operators of the sweeper must be informed about the dangers related to use of the machine.
- Operators of the sweeper must be rested, healthy and in good physical condition.
- Only loan the sweeper to people who are familiar with this model and its handling. Always provide this manual with the machine.
- Operators of the sweeper for the first time must read this manual before using the sweeper.
- Children should be supervised to ensure that they do not operate the sweeper incorrectly and endanger themselves.
- Operators who are prohibited from strenuous physical activity for health reasons should ask a doctor for advice on whether using the sweeper will not cause further health issues.
- The sweeper must not be operated after the consumption of alcohol, non-prescription or prescription medication that can affect motor skills or poor judgement.

1. Safety Instructions

The safety instructions are to be read in full to prevent danger to life and limb and avoid damage to property or the environment due to improper use of the sweeper.

The operator of the sweeper is responsible for injuries and damage that are caused due to non-compliance with these instructions.

1.1 Intended use

The sweeper is designed in accordance with recognized region, state and federal safety regulations.

The use of the sweeper can lead to harm of the operator or third parties, or damage to the sweeper and other property.

The sweeper is intended for commercial/trade use only and is not to be used inside a domestic residence. The sweeper is intended exclusively for removal of dirt, leaves, grass, paper and similar debris in an external environment.

Operation of the sweeper in snow affected area is not permitted. Any use in these types of environments will be deemed as improper use and void the warranty. The manufacturer and supplier will not be liable for damage caused because of this use. The user is solely liable because of the associated risks.

Claims of any kind due to damage caused by any improper use are excluded. The warranty can be voided at the discretion of the manufacturer/supplier if incorrect use is present at the time of a warranty claim.

The following information **must** be observed before operating the sweeper:

- These operating instructions (the complete manual) must be read in full before operation of the sweeper.
- compliance with the operating, maintenance, and storage conditions prescribed by the manufacturer.
- Compliance with Australian and Australian State Accident Prevention regulations and Safety regulations must be adhered to at all times.

The sweeper must not be used in hazardous areas which include hazardous liquid or hazardous particle substances. The sweeper must also not be used in or around flammable substances

1.2 Safety instructions for operation/Maintaining operating safety

The operator must be wearing protective clothing as required by Australian Federal or State regulations. Loose objects on the operators body or operating area can get caught in the sweeper and cause harm to the operator.

- The operator must use appropriate footwear for the surface in which the sweeper is being operated on.
- The user should wear a dust proof facial mask if operating in dusty areas.
- The operator should use appropriate gloves while operating the machine.

Operate the machine only for its intended purpose. All efforts should be made to protect the operator to ensure for the user and working environment.

Any faults that affect safety should be immediately rectified by a specialist technician.

The operator must observe all safety and danger instructions on the sweeper.

The operator must ensure the presence and legibility of all warning and information notices throughout the entire service life of the sweeper. Additional notices can be obtained from Lavorwash Australia Pty Ltd.

Use only genuine spare parts and accessories that have been approved by the manufacturer/supplier. These guarantee that the machine can be operated safely and without fault or danger.

Do not carry out any modifications, add/remove attachments or use any form of custom conversions on the sweeper that could impair safety without the approval of the manufacturer/supplier! The manufacturer/supplier excludes all liability from injuries or material damage caused by any modifications to the sweeper.

The maintenance work described in these instructions must be carried out completely and at the specified intervals either by the user or by an approved service agent.

2. Instructions for Use

- Before initial operation, inspect the package to ensure all parts are present and that during transit package and/or equipment has not broken.
- Before operation, please read this operation manual carefully and check that the sweeper is working as specified.
- This machine is not intended for cleaning any type of hazardous materials or liquids.
- Do not operate the sweeper while tilted and operating on one wheel. This will affect the longevity of the sweeper and can void the warranty.
- When sweeping and moving glass, metal or other dangerous particles, use gloves and safety glasses is recommended.
- Never attempt to modify your machine in any way. The manufacturer/supplier will not be liable for any damage caused to persons, natural environment or working environment. Such modifications can increase the risk of personal injury.
- When transporting the sweeper, do not lift or carry the sweeper by the handle on the hopper.
- Do not operate the sweeper to sweep up burning objects as there is a risk of fire.
- Do not operate the sweeper around objects and shelves as this increases the risk of injury to the operator.

3. Installations Instructions



1 Raise the handles and open the hopper bin to find the sweeper's two front brooms.



2 Lift the broom arms and begin unscrewing the 3 screws attached underneath.



3 Align the first broom to the holes in the arm and begin to fasten in place with the screws.



4 Loosen the handle knobs then pull the handlebar up to align it with the slots.



5 Push the handlebar down into the slots and tighten the knobs to lock it in place.



6 Adjust the height of the brushes using the back lever and side knobs for deeper cleaning.

4. Operating the Sweeper

- The operator should use the sweeper under normal operation and consider the surrounding environment when operating. Be cautious of people and objects around the sweeper that may unintentionally sweep in an outward direction.
- Depending upon the surface the operator intends to sweep, you can adjust the best height of the front and back brushes. The higher the brushes the less pressure on the surface. A higher brush may be less effective but will increase the longevity of the brush. The lower settings of the brush will be more effective at sweeping but harder to push and decrease the longevity of the brush.
- If debris is not going into the sweeper and waste bin, try sweeping quickly with some force over the debris pile to push the debris into the sweeper waste bin.
NOTE: Do not try and reverse the sweeper (pull it towards you), it will not properly collect debris in the reverse direction.

5. Sweeper Adjustments

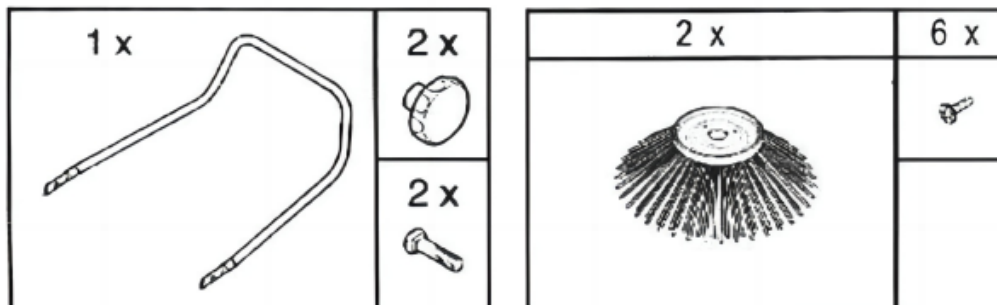

Handle and adjusting bolt assembly

Front brush and fixed bolt

Note: Do not over-twist to prevent bolt damage.

5.1 Adjusting Height of Brush

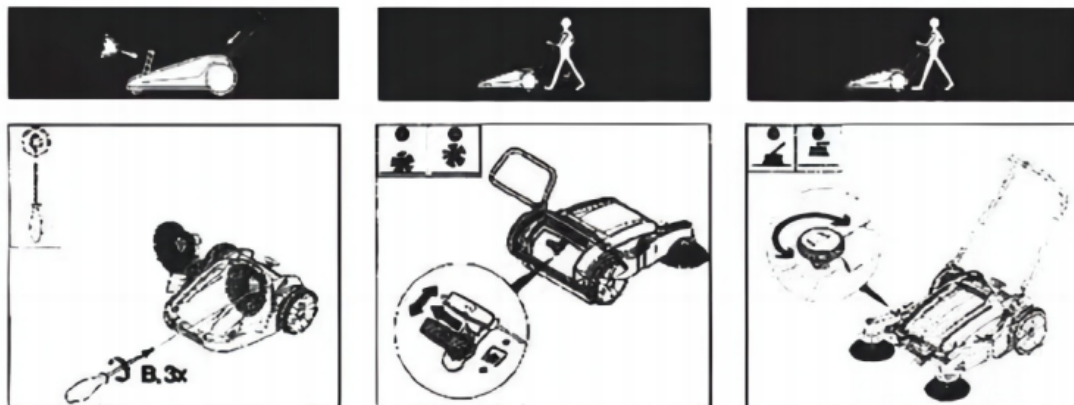

- The front brush is fastened with three screws

5.2 Main Brush Adjusting Handle

- "+"main brush down
- "-"main brush up

5.3 Front Brush Adjusting Handle

- "+"main brush down
- "-"main brush up

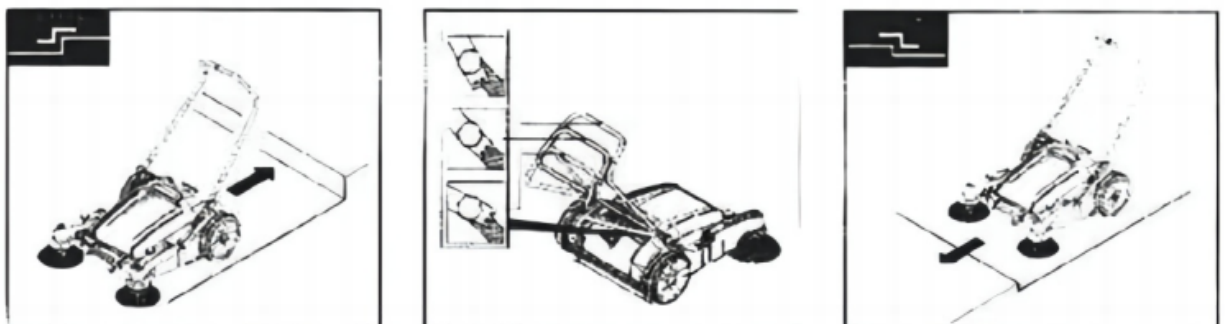

5.4 Adjustments and Cautions

- When backing the machine up to stairs, be clear by around 20-30cms of the first step.
- There are three adjustment settings for the handles.
- An approaching rise on the cleaning surface should be no more than 2.5cm

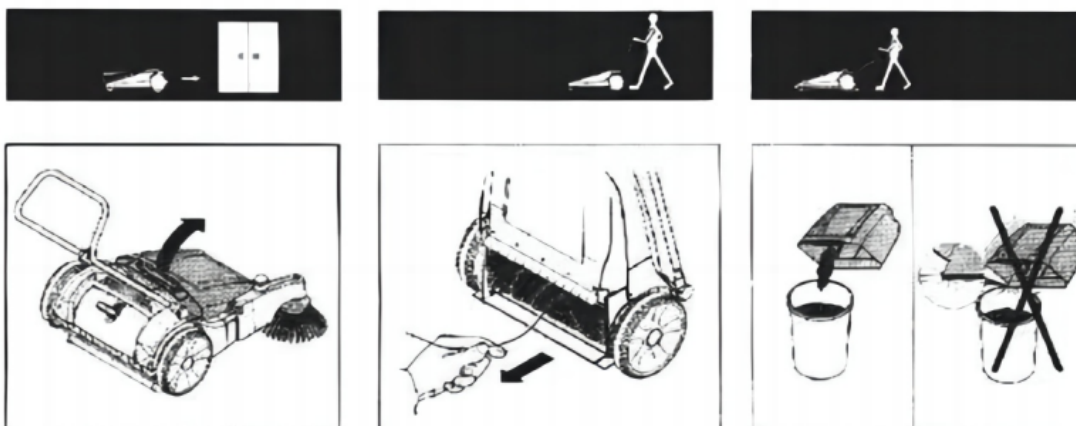

5.5 Cleaning

- Hold and lift up the waste bin handle to remove bin.
- When the main brush is entangled, tip up and remove any objects.
- To get rid of waste from the bin, clear it by tipping above the waste disposal. Do not tap it on a waste disposal bin as you may damage the sweepers waste bin.

6. Maintenance and Troubleshooting

6.1 Cleaning the machine

- Always clean, dust off and clear debris from the sweeper after prolonged use.
- Do not use any grease solvents or pressure washers to clean the sweeper. Use hot soapy water and a cleaning sponge.
- Wear safety gear when cleaning to reduce the risk of injury.
- Store the machine in a safe and dry area, preferably under cover.

7. Maintenance and Troubleshooting

Fault - The machine is not cleaning sufficiently.

Solution - One of the side brooms or the main rolling brush becomes blocked, stop work and remove the blockage. Wear safety gloves to reduce the risk of cuts or injuries from sharp objects.

Fault – Debris is not being picked up by the machine and/or it's coming out the sides.

Solution - Continue pushing the sweeper for a brief period, lift the sweeper up from the front (relying on the back wheels only) so that dirt falls to the back of the waste bin.

This helps to use the waste bins full capacity. When sweeping heavy material such as gravel, wood chips, and nails, the sweeper's centre of gravity shifts to the rear. This tends to lift the side brooms away from the surface and reduces cleaning efficiency. Adjust the side brooms downward accordingly or empty the waste bin if full.

Appendix 1 - About These Instructions

A1.1 Technical further development

We are continuously working on development of all our products. We therefore reserve the right to make changes in the scope of delivery with respect to form, technology, and equipment.

No claims can therefore be derived from information and illustrations contained in these instructions.

A1.2 Target group

These instructions are intended for the user of this sweeper.

PARTS AND AFTER SALES SERVICES

Contact	Lavorwash Australia Pty Ltd
	Number: 13 000 LAVOR (52867)
Details	Email: sales@lavorwash.com.au
	Address: 7/76 Rushdale Street, Knoxfield, Victoria 3180
	Website: www.lavorwash.com.au



LAVOR
SIMPLY STRONGER